

# CORNER RESTORATION

**CORNER:** E1/4 SEC. 31, TWP. 7 S., RANGE 28 E., W.M.

**ORIGINAL SURVEY BY:** Frank W. Campbell

**CONTRACT NUMBER:** 521

**CONTRACT DATE:** January 8, 1885

**SUBSEQUENT SURVEYS:**

► By Robert D. Bagett, Grant County Surveyor in 1995

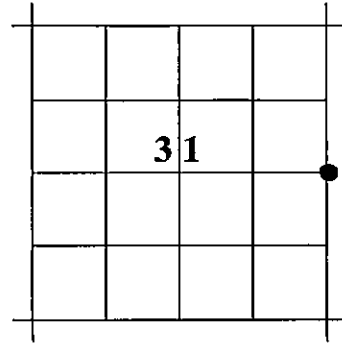

**ORIGINAL GLO DESCRIPTION:** Set a basalt stone 30x6x4 ins., 22 ins. in the ground for 1/4 sec. cor. marked 1/4 on W. face and raised a mound of stone alongside.

► 1995 BAGETT'S DESCRIPTION: Found a basalt stone 35"x6"x4" broken in two pieces, the top piece being marked 1/4. . . I set a 1 1/2"x30" galv. iron pipe, 19" in the ground, with attached Grant County Surveyor brass cap, marked as shown. From which I scribe new bearing trees: A juniper 6" diam. bears S21°E, 119.6 ft. marked 1/4 S32 CSBT; A juniper 10" diam. bears S75°W, 122.5 ft. marked 1/4 S31 CSBT; A juniper 13" diam. bears N51°W, 141.8 ft. marked 1/4 S31 CSBT; I set a new reference point: a 5/8"X30" iron pin with bears N45°E, 25.00 ft., with attached alum. cap marked GRANT COUNTY SURVEYOR RP1 1995 OPLS 598

**EVIDENCE FOUND AND NEW ACCESSORIES:** Found the brass cap monument set by Bagett in 1995. The monument is in good condition in a 3 ft. mound of stone. Also found the reference point set by Bagett in good condition. We placed a fiberglass location post about 2.5 ft. East of mound of stone. We placed a fiberglass location post alongside the mound of stone.

The bearing trees are all in good health with partially healed blazes and visible scribing. We reattached the BT tags to the bearing trees and measured the diameters of the bearing trees scribed by Bagett in 1995. New diameters are as follows:

Southeast BT is now 10" diam.  
Southeast BT is now 13" diam.  
Northwest BT is now 14" diam.

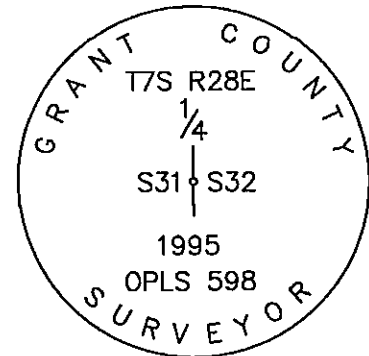

**STATE PLANE COORDINATES (3601 OR N)**

Reference Datum: NAD83 From OPUS solution

Northing: 458,404.6 ft.  
Easting: 8,484,992.0 ft.  
Ellip. Ht: 2,745.2 ft.

**RESTORATION BY, STAMP AND DATE:**

Michael C. Springer, PLS, Grant County Surveyor  
Jason L. Hatfield, PLS, Deputy County Surveyor

Surveyed November 15, 2012

RECEIVED AND FILED  
GRANT COUNTY SURVEYOR

NOV 16 2012

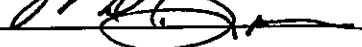
BY: 



EXPIRES: 6/30/2014